

Dobradiça Caneco 35 com Amortecimento Integrado - Calço Fixo - Linha LEVE

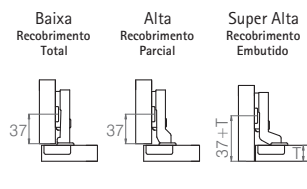

- Material: Dobradiça e calço em aço
- Acabamento: Niquelado
- Fixação: Parafusos
- Calço integrado/fixo na dobradiça
- Regulagem tridimensional
- Fechamento com amortecimento incluso
- Ângulo de abertura 95°

Regulagens Caneco 35

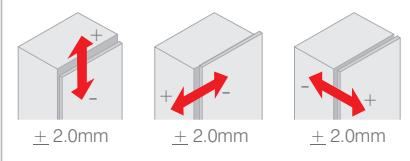

Aplicação do calço

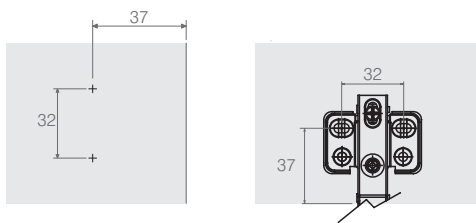

Aplicação do caneco

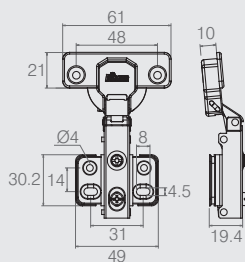
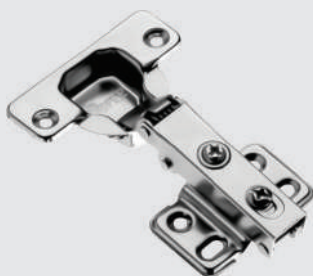
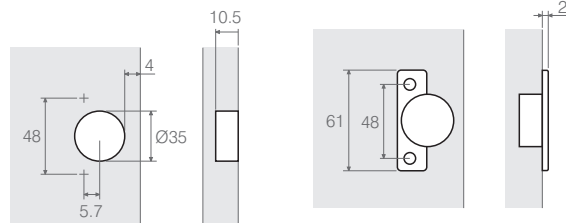

Dobradiça Caneco 35 Leve  
Colo Baixo com Calço Fixo

4115412990  
com amortecimento

- Material: Aço
- Acabamento: Niquel (421)

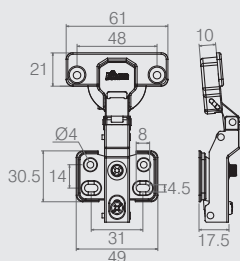
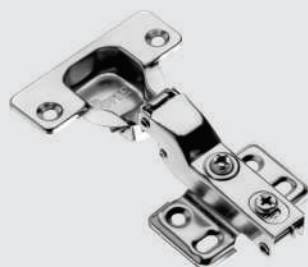

Dobradiça Caneco 35 Leve  
Colo Alto com Calço Fixo

4115402991  
com amortecimento

- Material: Aço
- Acabamento: Niquel (421)

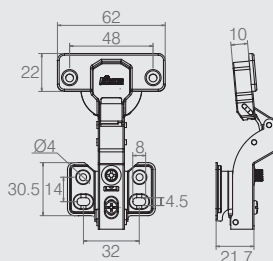
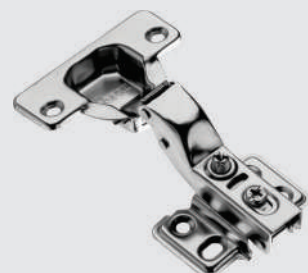

Dobradiça Caneco 35 Leve  
Colo Super Alto com Calço Fixo

4115592996  
com amortecimento

- Material: Aço
- Acabamento: Niquel (421)